

Contactors (low range)

DILM7-...; DILM9-...; DILM12-...

Dimensions are in millimeters.
Not intended for manufacturing purposes.

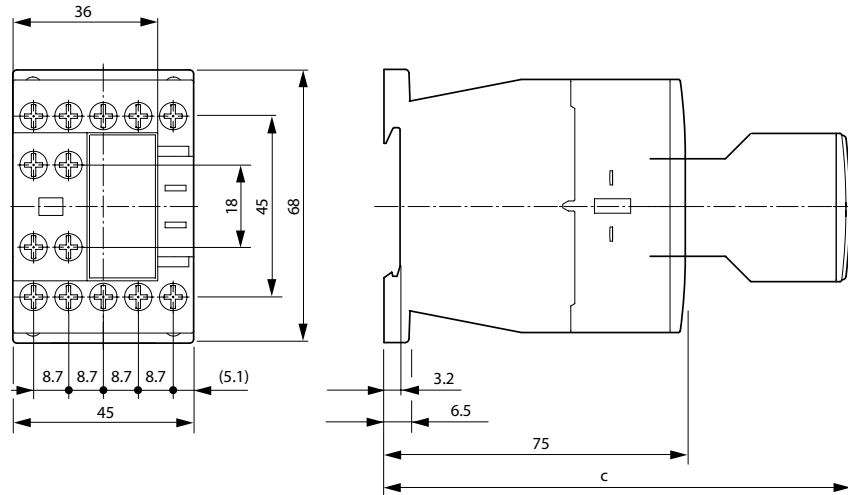

| Auxiliary Contact | c |
|-------------------|-----|
| DILM32-XHI | 117 |
| DILA-XHI | 117 |
| DILA-XHI...T | 125 |

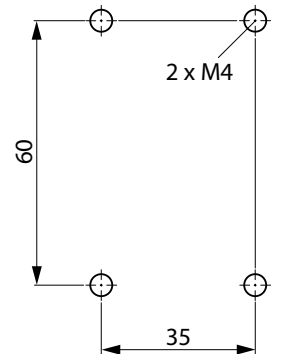

DILMF8-...; DILMF11-...; DILMF14-...; DILM(F)17-...; DILM(F)25-...; DILM(F)32-...

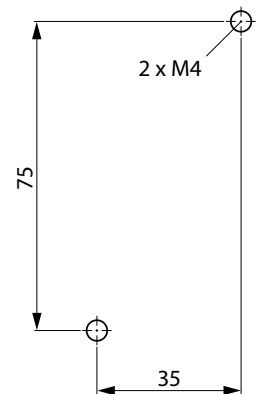
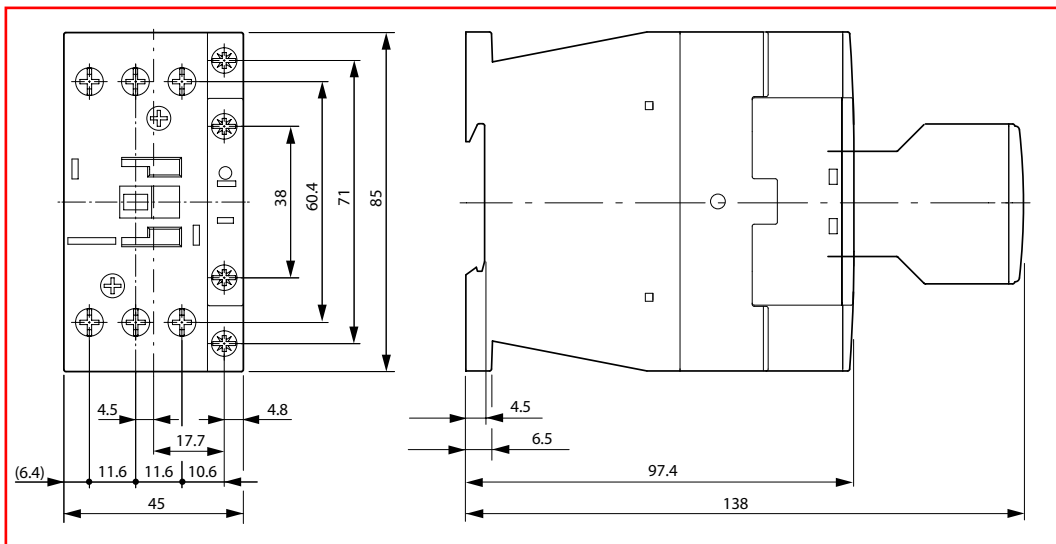

Sideways distance to grounding parts: 6mm